



COMPATIBILITY TABLE

DISC BRAKE CALIPERS
SUPER RECORD 13 PLATFORM

Campagnolo®

COMPATIBILITY TABLE

| STANDARDS FOR FORK / FRAME | COMPATIBLE DISCS WITH FORK / FRAME | SUPER RECORD 13 PLATFORM (BRAKE CALIPERS AND ADAPTERS) |
|--|--|--|
| FORK WITH FLAT MOUNT STANDARD (distance between threaded holes equal to 70 mm) | 140 mm | CL02-DB140 + AC21-DBADF adapter in 140 set up |
| | 160 mm | CL02-DB160F or CL02-DB140 + AC21-DBADF adapter in 160 set up |
| | 160 mm | CL02-DB140 + AC21-DBADF adapter in 140 set up |
| | 180 mm | not possible (does not exist Campagnolo 180 disc) |
| FORK WITH 34 mm BRAKE MOUNT HOLE SPACING (Standard flat mount rear chainstay) | 160 mm | CL02-DB140 + screws AC18-DBSCxx (Table "Screw length / frame thickness") |
| FORK WITH ALTERNATIVE STANDARDS | Please refer to the compatibility information provided by the frame/ fork manufacturer | CL02-DB140 + screws and adapters compliant with the fork manufacturer's specifications |
| REAR FRAME WITH STANDARD FLAT MOUNT (Brake mount thru-hole spacing of 34 mm) | 140 mm | CL02-DB140 + screws AC18-DBSCxx (Table "Screw length / frame thickness") |
| | 160 mm | CL02-DB160R + screws AC18-DBSCxx (Table "Screw length / frame thickness") or CL02-DB140 + AC21-DBADR adapter + AC18-DBSCxx screws (Table "Screw length / frame thickness") |
| | 160 mm | CL02-DB140 + screws AC18-DBSCxx (Table "Screw length / frame thickness") |
| | 180 mm | not possible (does not exist Campagnolo 180 disc) |

TABLE "SCREW LENGTH / FRAME THICKNESS"

| SCREW PART NUMBER | L = SCREW LENGTH (mm) | FRAME THICKNESS (mm) |
|-------------------|-----------------------|----------------------|
| AC18-DBSC19 | 19 | 10-14 |
| AC18-DBSC24 | 24 | 15-19 |
| AC18-DBSC29 | 29 | 20-24 |
| AC18-DBSC34 | 34 | 25-29 |
| AC18-DBSC39 | 39 | 30-34 |
| AC18-DBSC44 | 44 | 35-39 |

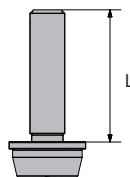

WARNING!

- The CL02-DB140 brake caliper can be used in any configuration (both at the front on the fork and at the rear on the frame), using specific adapters if needed.
- The CL02-DB160F brake caliper can only be used on the front with a traditional flat mount fork, with a 160 mm disc (no adapters required).
- The CL02-DB160R brake caliper can be used at the rear with traditional flat mount frames, with a 160 mm disc (no adapters required). It can also be used at the front, with traditional flat mount forks, with a 160 mm disc (the AC21-DBADF adapter must be mounted in the '140 position').

The fork with classic Flat Mount standard can be compatible with rotors:

- 140 or 160 mm (traditional standard configuration)
- 160 or 180 mm (setup used on some road and gravel bikes).

Similarly, with classic Flat Mount standards on the rear chainstay, the frame can be compatible with rotors:

- 140 or 160 mm (traditional standard configuration)
- 160 or 180 mm (setup used on some road and gravel bikes).